

Heavy Duty Camlock Flange for Marine Hose Flogging Spanner Type

**Allied Marine
LOGISTICS
LIMITED**

NO MORE LOOSE OR BROKEN CAMS!

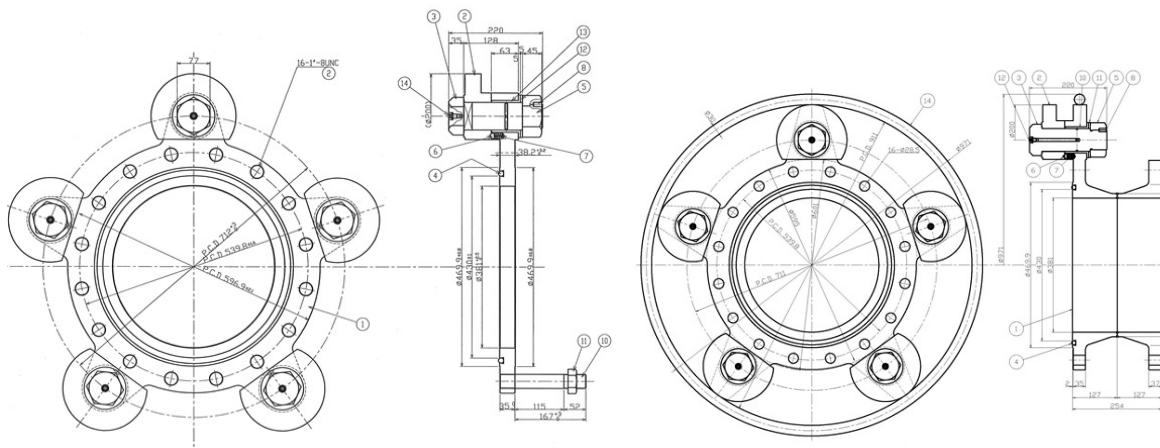
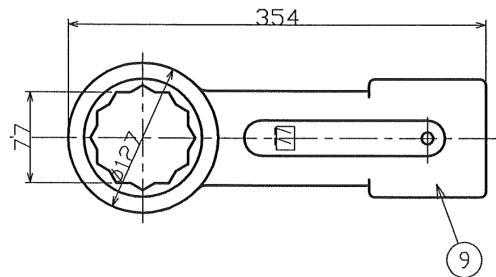

Heavy Duty Design:

- Crew Proof:** Cams are designed to be **tightened by flogging spanner** with 4lb lump hammer.
- Impact Proof:** Special flange is forged with **integral cam housings** eliminates weak welding points.
- Surge Proof:** The completed camlock flange can be factory hydro tested up to **31.5 bar**.
- Long Design Life:** **15-20 year design life** for the camlock flange body.
- Long Service Life:** **5 year service life** for cams proven at some of the world's busiest terminals.
- Cam Ring:** Optional handling and fendering camguard ring made from **50mm solid bar**.

Ease of Operation and Maintenance:

- Cams are held in fully open position by **spring loaded ball bearing latch**.
- Dovetail O-ring groove** prevents O-ring from falling out during connection and disconnection.

Sizes: 12", 16", 20", ASME#150 or ASME#300

Type: Short Spool Type Studed Type Camguard option

Quality: Made in Japan

Allied Marine Logistics Limited
3rd Floor, 207 Regent Street
London, W1B 3HH
United Kingdom

Tel: +44 (0)20 3355 8781
Fax: +44 (0)20 3051 5716
www.almalog.co.uk

Marine Hose Specialists